

HALIFAX

HRTG-2024-00773 – 8 Sullivan's Hill, Bedford

Request to Include Property in the Registry of
Heritage Property for the Halifax Regional
Municipality

March 18, 2025

Location

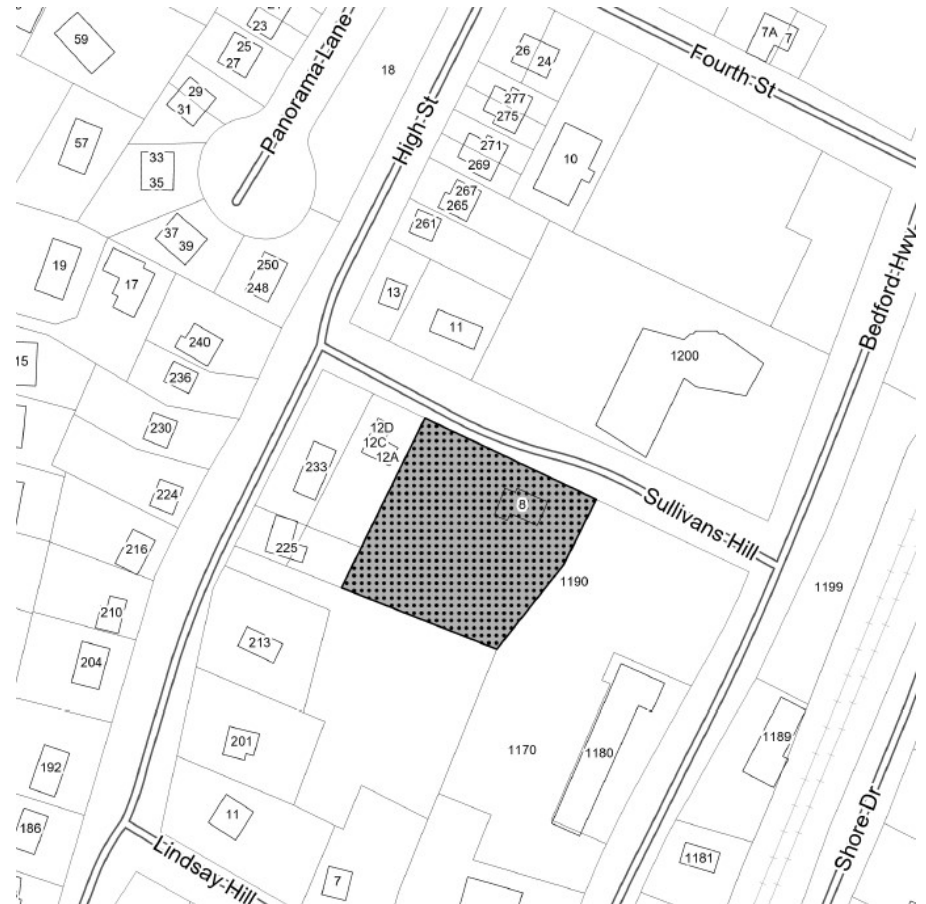

HRTG-2024-00773 – 8 Sullivan's Hill

HALIFAX

Registration for Evaluation Criteria – Buildings

Criterion	Maximum Score
1. Age	25
2.[a] Historical <u>or</u> [b] Architectural Importance	20
3. Significance of Architect / Builder	10
4. Architectural Merit: Construction Type <u>and</u> Style	20
5. Architectural Integrity	15
6. Relationship to Surrounding Area	10
Total	100

2

1. Age

- In 1861, Andrew Heffler received a Crown grant for large parcel between Bedford Basin and Nova Scotia Railway
- Andrew sold a portion of the property to his son, Joseph, who was a carpenter
- Joseph built the subject property circa 1894 on the lot



Red Gables circa 1935 (Source: Edwards 2007)

2a. Historical Importance

- Heffler family was one of the largest land-owning families in Bedford in the mid-19th century
- DeWolf family lived at Red Gables from 1903 to 1910
- Sullivan family owned the property from 1910 to 2023
- Street name changed from Third Street to Sullivan's Hill in their honour



Eugene Sullivan and his children, Mary and Paul (Source: Edwards 2005)

3. Significance of Architect

- Built by Joseph Heffler, carpenter
- Heffler is attributed to building several properties within the immediate area during the late 19th century, unknown if any structures remain



8 Sullivan's Hill
(July 2024)

4a. Architectural Merit *[Construction Type]*

- Brick and stone foundation
- Concrete foundation on later additions
- Balloon frame construction



Stone foundation with
concrete on addition (July
2024)

4b. Architectural Merit *[Style]*

- Character-defining elements include but are not limited to:
 - Shingle cladding and decorative brackets;
 - Decorative wood ornamentation such as the gable finial;
 - Red coloured roof and gable detailing; and,
 - High pitched gable roof with truncated hipped gables.



5. Architectural Integrity

- Modifications to the original structure include:
 - Ell added in 1912, likely the rear addition;
 - Upstairs bedroom constructed in 1934, likely the south side front addition;
 - Verandah replaced with sun porch, also made at same time as the front addition; and,
 - Rear addition containing bathroom and kitchen.



6. Relationship to Surrounding Area

- Last remaining structure known to be built by Heffler family on original family lot, surrounded by mature trees and vegetation
- One of the few remaining 19th century structures in Bedford
- Visual connections to the railway and Bedford Basin



View of Bedford Basin near
8 Sullivan's Hill (July 2024)

Evaluation Criteria – HAC Scoring

Criterion	Score Awarded by HAC
1. Age	13
2.[a] Historical Importance	14
3. Significance of Architect / Builder	3
4. Architectural Merit: Construction Type <u>and</u> Style	3 <u>and</u> 5
5. Architectural Integrity	8
6. Relationship to Surrounding Area	8
Total	54

10

Recommendation

That Halifax Regional Council approve the request to include 8 Sullivan's Hill, in the Registry of Heritage Property for the Halifax Regional Municipality, as shown on Map 1 of the staff report dated December 16, 2024, as a municipal heritage property under the *Heritage Property Act*.

HALIFAX

Thank you