

January 14, 2025

Re: Item No. 12.1

**HALIFAX**

## **HRTG-2024-00687: 1300 Oxford Street**

Request to Include Property in the Registry of Heritage Property for the Halifax Regional Municipality

# Location



Location of 1300 Oxford Street

# Registration for Evaluation Criteria – Buildings

Criterion	Maximum Score
1. Age	25
2.[a] Historical <u>or</u> [b] Architectural Importance	20
3. Significance of Architect / Builder	10
4. Architectural Merit: Construction Type <u>and</u> Style	20
5. Architectural Integrity	15
6. Relationship to Surrounding Area	10
<b>Total</b>	<b>100</b>

# 1. Age

Cornerstone was laid down in 1948.

The church was dedicated on April 16, 1950.

A rear wing was added to the church in 1958.



Cornerstone with 'A.D. 1948' Inscription

<b>OXFORD</b>	St. No. <u>10</u>	APPLICATION FOR NEW BUILDING	No. <u>34766</u>			
To the Inspector of Buildings,		Halifax, N. S.,	<u>27</u> day of <u>MAY</u> 19 <u>48</u>			
Sir--The undersigned hereby applies for a permit to build according to the following specifications and in accordance with the detailed plans and specifications submitted.						
Location	<u>OXFORD</u>	St. No. <u>10</u> - <u>W</u> Side	<u>W</u> between <u>C. BURT</u> St. and <u>South</u>			
Owner	<u>FRED BARTON</u>	Builder	<u>BLENFELD GWS Co</u> Estimated Cost <u>500.000.00</u>			
Class		Material	<u>STONE</u> Purpose of Building	<u>CHURCH</u>		
Size of main building	<u>69</u> Ft. front	<u>165</u> Ft. deep	Ft. in height	No. of Stories	Nearest part to Street line	<u>30</u> Ft.
Size of extension	"	"	"	"	"	"
Foundation wall, material	<u>CONC.</u>	Thickness	<u>14"</u>	Chimney, how constructed	<u>BRICK - LINED</u>	
Style of roof and material	<u>PICH - ASPHALT</u>	No. of elevators and for what purpose				
What kind of fire stop is to be used?	<u>Concrete</u>	Date of permit from Health Board				
Permission is also applied for, to enclose that portion of the street in front of the proposed building extending into the street five ft.						
The undersigned hereby agrees that all work on the said buildings shall be done in strict accordance with the laws and ordinances of the City of Halifax and also with the conditions printed on the back of the permit which have been read by the applicant and that every obstacle will be removed from the street on or before the <u>1</u> day of <u>June</u> 19 <u>49</u> on which date this permit expires.						
						Applicant
						<u>Blenfild Const Co</u> <u>per H.M. Nolan</u>

Building Permit 1948

## 2b. Architectural Importance

Designed by Francis Bruce Brown in a Neo-Gothic style.

### Neo-Gothic style:

- Popular in early twentieth-century
- Grand size, symmetrical facades
- Monochromatic stone or brick exterior finishes
- Borrow design elements from the Gothic Revival style (1830-1900)



1300 Oxford Street



# 3. Significance of Architects / Builders

The subject building is designed by an Ontario firm Francis Bruce & Brisley.

## Francis Bruce Brown (1899-1983):

- Designed over 100 churches across Canada
- Known for modern Gothic ecclesiastical architecture
- President of Royal Architectural Institute of Canada (1964-65)



# 3. Significance of Architects / Builders

Halifax architect Allan F. Duffus served as the supervising architect.

## Dr. Allan Ferguson Duffus (1914-1997):

- Halifax renowned architect and preservationist
- Led many Halifax heritage preservation projects
- President of the Heritage Trust of Nova Scotia
- Governor of Heritage Canada (1974-79)



Dr. Duffus led the Robertson Hardware Building restoration project, which became part of the Maritime Museum complex.

# 3. Significance of Architects / Builders

## Builder: Brookfield Construction Company

- Established in the mid-19th century by John Brookfield
- Contributed to St. John's reconstruction post-Great Fire (1892).
- Major projects:
  - Anglican Cathedral and Bank of Nova Scotia in Saint John
  - Old Post Office, Victoria General Hospital Nurses Residence and Queen Elizabeth High School, in Halifax



Old Post Office (Art Gallery of Nova Scotia built by Brookfield Construction Company



## 4a. Architectural Merit *[Construction Type]*

Hybrid use of reinforced concrete, steel beams, and wood

- Concrete columns reinforced with steel bars
- Steel beams used to achieve long spans and support wood elements
- Concrete/masonry walls finished with stucco (interior) and stone (exterior)

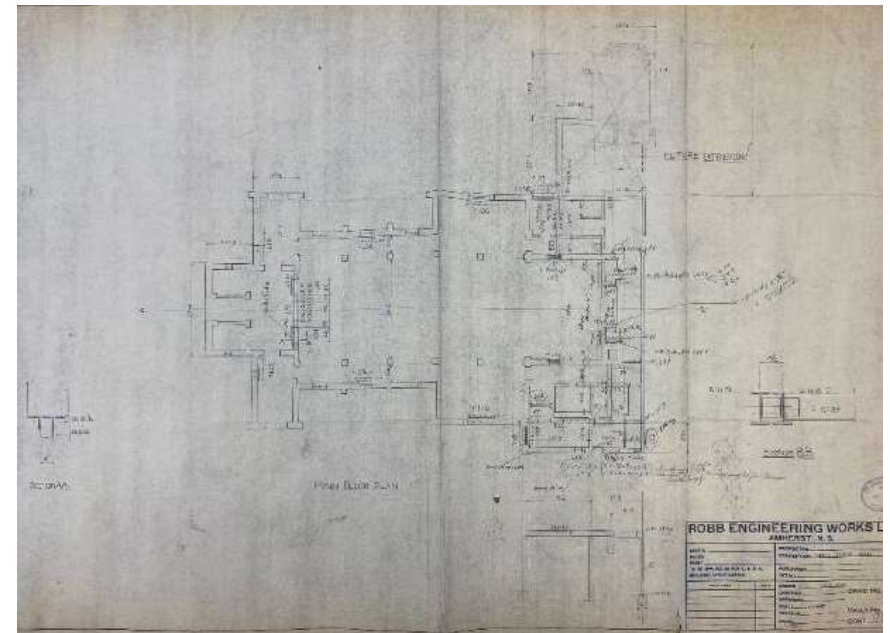

Construction Plan

## 4b. Architectural Merit *[Style]*

Character-defining elements are as listed in the Staff Report, but most notably include:

- Square tower with Gothic louvres, windows and doors;
- The church hall with stone cladding, sandstone surrounding fenestration and gabled roof;
- The rear wing with stone cladding, sandstone surrounding fenestration, and a gabled hall;
- Cross gables; and
- The stained-glass liturgical windows.



# 5. Architectural Integrity

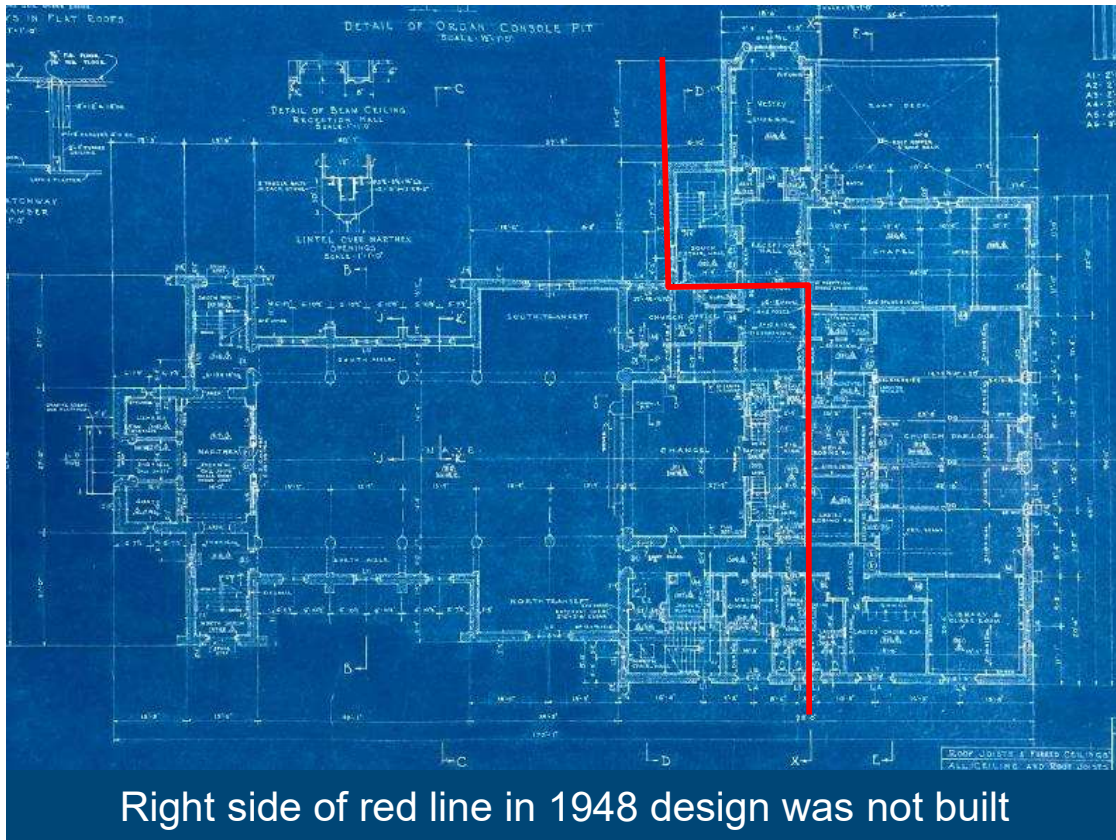

No noticeable alteration on the north, east, and south elevations.

A rear addition was added to the church in 1958

- Was in the 1948 design but not built
- Designed and adjusted by Bruce Brown & Brisley
- Respect the original design



# 5. Architectural Integrity

The rear addition contributes to architectural integrity

Respect the original massing and style

- Same rough-cut stone cladding
- Similar stone window surroundings
- A gabled hall similar to original gables



West and south elevations of the rear wing

# 6. Relationship to Surrounding Area



Surrounded by mid-density residential buildings and the Dalhousie campus

A railway separated it from a low-rise resident neighbourhood

The highest point of the west Oxford streetscape.

Unique Neo-gothic style in the surroundings but does not stand out abruptly



# Score Awarded

Criterion	Score Awarded
1. Age	3
2.[a] Historical <u>or</u> [b] <b><u>Architectural Importance</u></b>	13
3. Significance of Architect / Builder	9
4A. Architectural Merit: Construction Type <u>a</u>	2
4B. Architectural Merit: Style	6
5. Architectural Integrity	14
6. Relationship to Surrounding Area	4
<b>Total</b>	<b>51</b>

# Recommendation

That Halifax Regional Council approve the request to include 1300 Oxford Street, Halifax, in the Registry of Heritage Property for the Halifax Regional Municipality, as shown on Map 1 of the staff report dated September 18, 2024, as a municipal heritage property under the *Heritage Property Act*.

**HALIFAX**

**Thank you**